



A-ONE DECOR
DESIGNING THE FUTURE

ENRICHING MODERN DESIGN CONCEPTS

WALL CLADDING

2024



WALLON[®]
Seamless Designer Planks

WHY INTERIOR WALL CLADDING?



Water
Resistant



Natural Wood
Pattern



Eco
Friendly



Easy
Maintenance



Moth
Resistant



No
Stain



PS FOAM WALL CLADDING

A1001

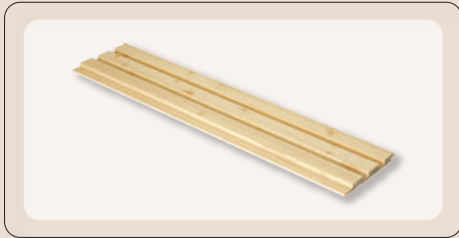

A1002



A1003

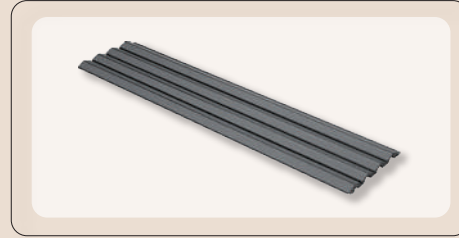

A1004



A1005



A1006

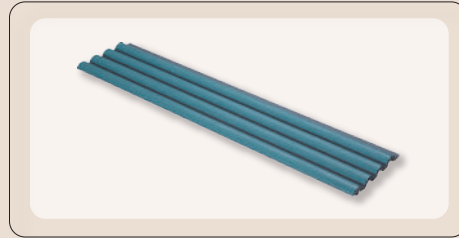

A1007



A1008

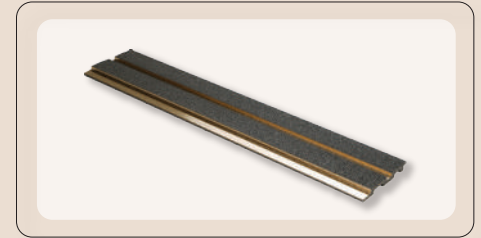

A1009



A1010



A1011



A1012



A1013



A1014

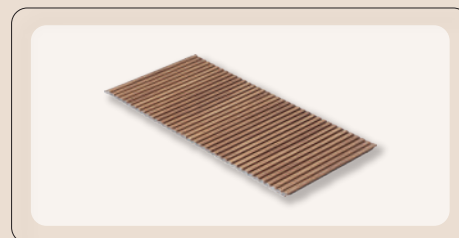

A1015



A1016





Wallon | A1001

SIZE :
5800mm x 115mm x 12mm



A-ONE DECOR
DESIGNING THE FUTURE



Wallon | A1002

SIZE :
5800mm x 115mm x 12mm



A-ONE DECOR
DESIGNING THE FUTURE

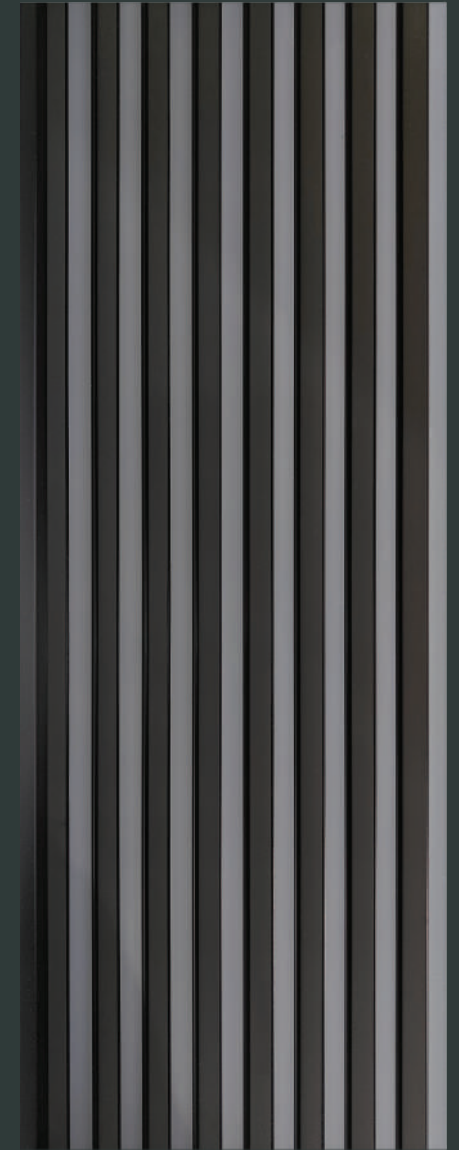

Wallon | A1003

SIZE :
5800mm x 125mm x 12mm



A-ONE DECOR
DESIGNING THE FUTURE



Wallon | A1004

SIZE :
5800mm x 120mm x 12mm



A-ONE DECOR
DESIGNING THE FUTURE



Wallon | A1005

SIZE :
5800mm x 115mm x 12mm



A-ONE DECOR
DESIGNING THE FUTURE

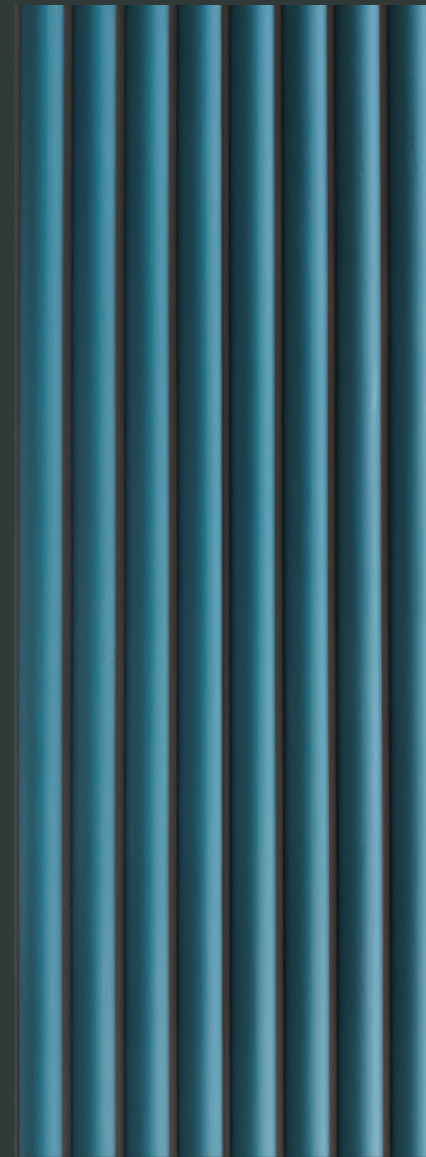

Wallon | A1006

SIZE :
5800mm x 120mm x 12mm



A-ONE DECOR
DESIGNING THE FUTURE



Wallon | A1007

SIZE :
5800mm x 125mm x 12mm



A-ONE DECOR
DESIGNING THE FUTURE

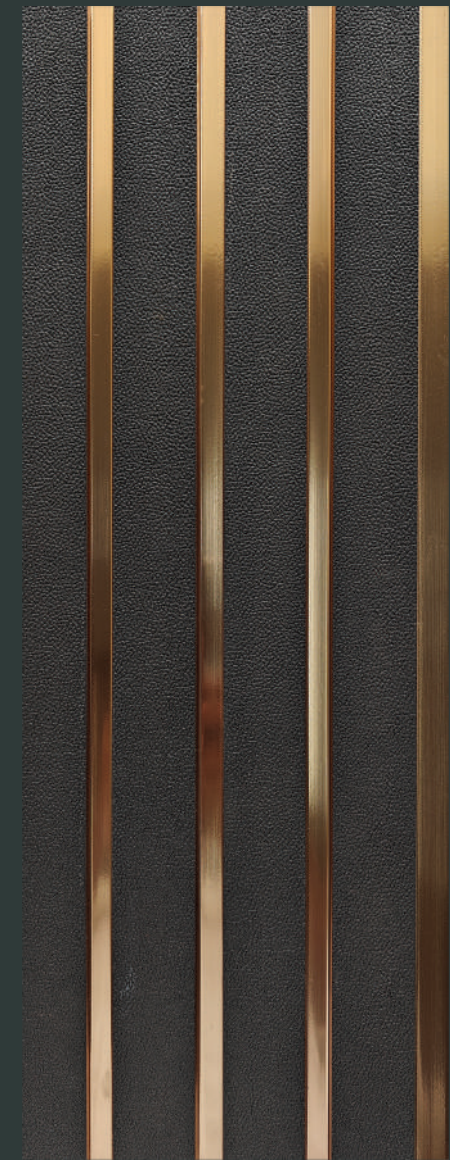

Wallon | A1008

SIZE :
5800mm x 115mm x 12mm



A-ONE DECOR
DESIGNING THE FUTURE



Wallon | A1009

SIZE :
5800mm x 140mm x 12mm



A-ONE DECOR
DESIGNING THE FUTURE



Wallon | A1010

SIZE :
5800mm x 140mm x 12mm



A-ONE DECOR
DESIGNING THE FUTURE



Wallon | A1011

SIZE :
5800mm x 300mm x 6mm



A-ONE DECOR
DESIGNING THE FUTURE



Wallon | A1012

SIZE :
5800mm x 300mm x 6mm



A-ONE DECOR
DESIGNING THE FUTURE



Wallon | A1013

SIZE :
5800mm x 300mm x 6mm



A-ONE DECOR
DESIGNING THE FUTURE



Wallon | A1014

SIZE :
5800mm x 300mm x 6mm



A-ONE DECOR
DESIGNING THE FUTURE



Wallon | A1015

SIZE :
5800mm x 300mm x 6mm



A-ONE DECOR
DESIGNING THE FUTURE



Wallon | A1016

SIZE :
5800mm x 300mm x 6mm



A-ONE DECOR
DESIGNING THE FUTURE

WITHOUT JOIST

(Note: Before installation, please make sure the wall is smooth and solid.)



PS FOAM WALL PANEL



EDGE COVER



NAIL FREE GLUE



CUTTING SAW



NAIL GUN



MEASURING TAPE

WITH JOIST

(Note: Please use joist if the wall is uneven and not smooth.)



HAMMER



EXPANSION SCREW



ELECTRIC DRILL



TIMBER JOIST

MAIN COMPONENTS

INSTALLATION GUIDE

STEP BY STEP

STEP 1



STEP 2



STEP 3



STEP 4

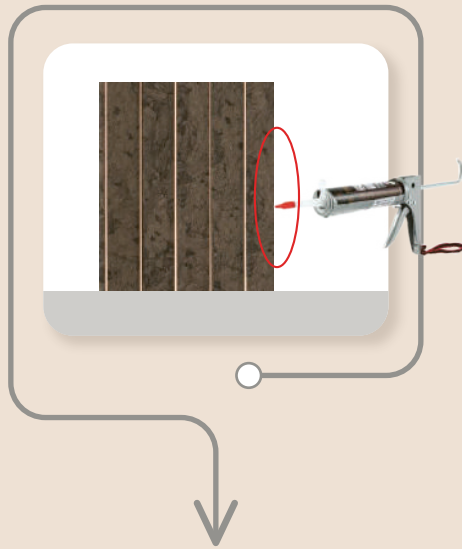

Use the nail-free glue or gun nail to fix the small edge strip.

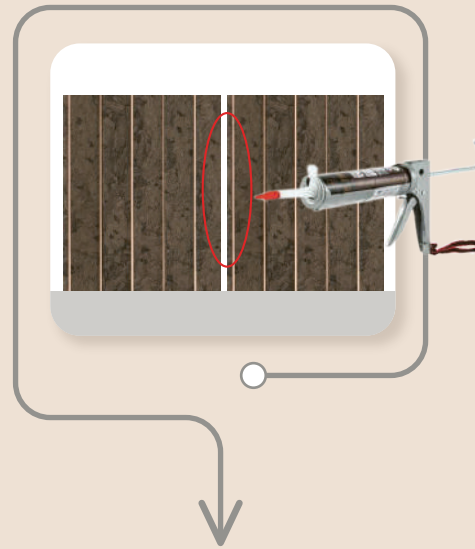

Fix wall panels by nail gun on the edge, installing the panels one by one.

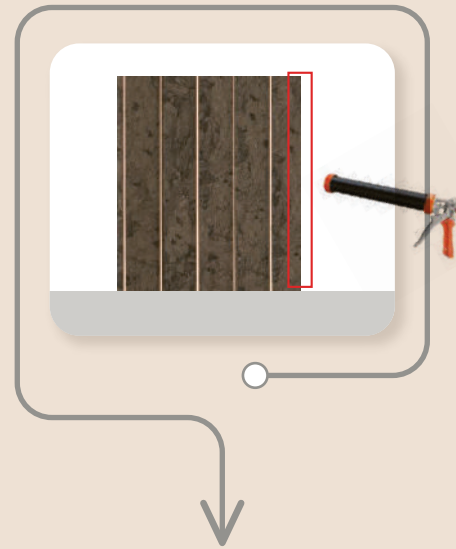

Use the nail-free glue or structural glue to the back of each ps foam wall panel.

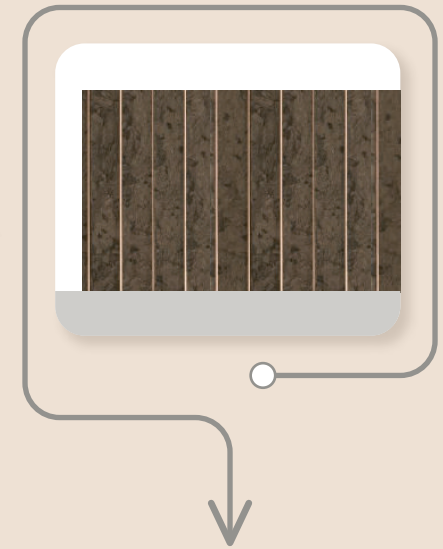

Fix the last edge strip in the end by wall cladding installation finished.



A-ONE DECOR

DESIGNING THE FUTURE



2/28-30 Essington Street Mitchell ACT 2911, Australia



info@aonedecor.com.au



+61 478 914 228 / +61 478 665 201



www.aonedecor.com.au



Scan for Web